

ChemDrain[®]

DC-CD

CHARLOTTE
PIPE AND FOUNDRY COMPANY

DIMENSIONAL CATALOG

ChemDrain[®] CPVC Chemical Waste Drain System

[Updated August 26, 2013]

You can't beat the system.®

© 2005-2013 Charlotte Pipe and Foundry Company

**ChemDrain® CPVC Chemical Waste
Drain System Dimensions**



All products manufactured by Charlotte Pipe and Foundry Company are proudly made in the U.S.A.

Table of Contents

	<u>Page</u>
ChemDrain®CPVC Schedule-40 Pipe Dimensions	4
ChemDrainCPVC Schedule-40 Fitting Dimensions.....	5-24
Warranty	27

This catalog accurately reflects dimensional information to the best of our knowledge. If the dimensions on your job are critical, please verify dimensional information with our factory.

This dimensional catalog accurately reflects our product line at the time the catalog was printed. However, we add items on an ongoing basis to better serve our customers. Please refer to our current list price sheets for an accurate listing of items offered.

Charlotte Pipe® products are manufactured to the applicable ASTM standard. Charlotte Pipe and Foundry cannot accept responsibility for the performance, dimensional accuracy, or compatibility of pipe, fittings, or couplings not manufactured or sold by Charlotte Pipe and Foundry.

Charlotte Pipe and ChemDrain are registered trademarks of Charlotte Pipe and Foundry Company.

ChemDrain® CPVC Pipe

Possession of this price list shall not be construed as an offer to sell the products listed.
ChemDrain is a registered trademark of Charlotte Pipe and Foundry Company.



ChemDrain® CPVC Schedule 40 Pipe, Type IV, Grade 1

ASTM F 2618

CPVC SCHEDULE 40 (LIGHT GRAY)			PLAIN END		CPVC 4120	
PART NO.	NOM. SIZE	UPC # 611942-	QTY. PER SKID	AVG. OD (IN.)	MIN. WALL (IN.)	WT. PER 100 FT. (LBS.)
AW 14015	1½" x 10'	10732	1720'	1.900	.145	55.3
AW 14002	2" x 10'	10733	990'	2.375	.154	74.3
AW 14003	3" x 10'	10734	1040'	3.500	.216	154.2
AW 14004	4" x 10'	10735	600'	4.500	.237	219.6
AW 14006	6" x 10'	10736	280'	6.625	.280	386.1
AW 14008	8" x 10'	11363	180'	8.625	.322	581.1

NOTE: Full skids of pipe are polyethylene wrapped for cleanliness and UV protection.

NSF Listed. Meets All Requirements of ASTM F 2618.

! WARNING

Testing with or use of compressed air or gas in PVC / ABS / CPVC pipe or fittings can result in explosive failures and cause severe injury or death.

AIR/GAS

- NEVER test with or transport/store compressed air or gas in PVC / ABS / CPVC pipe or fittings.
- NEVER test PVC / ABS / CPVC pipe or fittings with compressed air or gas, or air over water boosters.
- ONLY use PVC / ABS / CPVC pipe or fittings for water or approved chemicals.
- Refer to warnings in PPFA User Bulletin 4-80 and ASTM D 1785.

All products manufactured by Charlotte Pipe and Foundry Company are proudly made in the U.S.A.



ChemDrain® CPVC Fittings

CHEM
DRAIN
CPVC
FITTINGS

Hub Dimensions

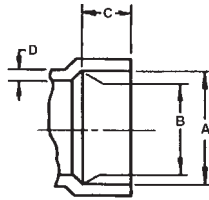

CPVC

SIZE	A	B	C	D
1½	1.915	1.895	.687	.156
2	2.390	2.370	.750	.156
3	3.520	3.495	1.500	.218
4	4.520	4.495	1.750	.250
6	6.647	6.614	3.000	.281
8	8.655	8.610	4.000	.322

PART NO. AW 1A

Waste Assembly, Sink Outlet

SIZE	A	B	C	D
1½	2 ⁷ / ₁₆	9 ⁹ / ₃₂	4 ⁹ / ₃₂	3 ²⁷ / ₃₂

Shaded area indicates new part.

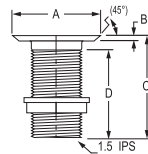

PART NO. AW 95C

Transition Coupling - ChemDrain CPVC to Steel, Cast Iron, Plain-end Glass or Any Other Schedule 40 or 80 IPS Size Plastic or Metallic Pipe
[300 Series Stainless Steel with Fluoroelastomer Gasket]

SIZE	SHIELD WIDTH	NUMBER OF CLAMPS
1½	2 1/8	2
2	2 1/8	2
3	2 1/8	2
4	2 1/8	2
6	3	4
8	4	4



PART NO. AW 96C

Transition Coupling - ChemDrain CPVC to Plain-end High-silicon Iron
[300 Series Stainless Steel with Fluoroelastomer Gasket]

SIZE	SHIELD WIDTH	NUMBER OF CLAMPS
2	2 1/8	2
3	2 1/8	2
4	2 1/8	2



PART NO. AW 1C

ChemDrain Low-VOC Solvent Cement



PART NO. AW 100C

Coupling
HUB X HUB

SIZE	A	B
1½	1/8	19/16
2	15/64	1¾
3	3/16	33/16
4	¼	3¾
6	¼	6¼
8	¼	8¼

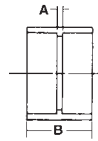

CHEM DRAIN CPVC FITTINGS

PART NO. AW 101C

Female Adapter
FPT X HUB

SIZE	A	B
1½	¼	¾
2	¼	7/8
3	5/16	1½
4	11/32	1¾
6	¼	3

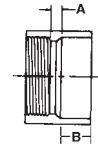

PART NO. AW 102C

Pipe Increaser-Reducer
HUB X HUB

SIZE	A
1½ X 2	17/32
1½ X 3	13/32
2 X 3	7/8
2 X 4	13/8
3 X 4	15/16
3 X 6	2
4 X 6	1¾

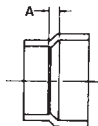

PART NO. AW 103PC

Trap Adapter-Male
SPIGOT X SLIP WITH PLASTIC NUT

SIZE	A
1½	3/16

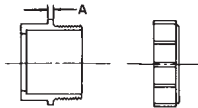

PART NO. AW 103RC

Trap Adapter-Male
with 1½" Plastic Nut and Washer
SPIGOT X SLIP WITH PLASTIC NUT

SIZE	A
1½	3/16

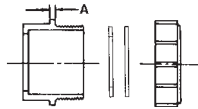

PART NO. AW 104RC

Trap Adapter-Female
with 1½" Plastic Nut and Washer
HUB X SLIP WITH PLASTIC NUT

SIZE	A
1½	3/16

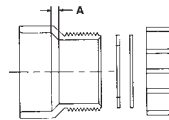

PART NO. AW 105XC

Fitting Cleanout Adapter
with Cleanout Plug (See AW 106C Dimensions)
SPIGOT X FPT

SIZE	A	B
1½	5/32	5/8
2	5/32	5/8
3	7/32	3/4
4	1/4	7/8
6	5/16	17/16
8	13/32	11/8

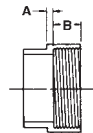

PART NO. AW 106C

Cleanout Plug
MPT

SIZE	A	B
1½	1⅜	⅝
2	1⅜	⅝
3	1¾	¾
4	1⅞	⅞
6	2	1

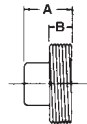

PART NO. AW 107C

Flush Bushing
SPIGOT X HUB

SIZE	A	C
2 x 1½	1⅞	⅝
3 x 1½	1¾	1
3 x 2	1¾	⅞
4 x 2	2	1⅞
4 x 3	2	½
6 x 3	3⅜	1⅝
6 x 4	3½	1¾
8 x 4	4⅝	2⅞
8 x 6	4⅞	1⅝

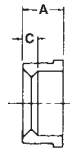

PART NO. AW 109C

Male Adapter
MPT X HUB

(Note: Not a trap adapter. Will not accept a tail piece.)

SIZE	A
1½	⅜
2	⅜
3	⅜
4	⅜
6	1⅞

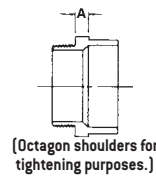

CHEM DRAIN CPVC FITTINGS

PART NO. AW 116C

SIZE	Cap SOCKET	
	A	C
1½	1 ¹⁵ / ₁₆	1 ⁵ / ₁₆
2	2 ⁵ / ₃₂	1 ³ / ₈
3	2 ¹⁵ / ₁₆	1 ²⁹ / ₃₂
4	3 ¹ / ₈	2 ¹ / ₃₂
6	4 ³ / ₄	3 ⁵ / ₈
8	6 ¹³ / ₃₂	4

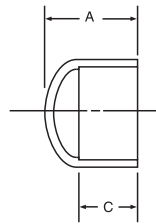

PART NO. AW 150MC

Floor Drain with CPVC Adjustable Top with 5" Round Grate and Membrane Collar

SIZE	A	B	C
1½ x 5	5	1½	4 ³ / ₁₆
2 x 5	5	2	4
3 x 5	5	3	4
4 x 5	5	4	3¾

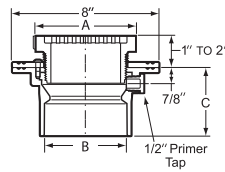

PART NO. AW 160MS**

Floor Drain with Stainless Steel Adjustable Top with 6" Round Grate and Membrane Collar

SIZE	A	B	C
1½ x 6	6	1½	4 ³ / ₁₆
2 x 6	6	2	4
3 x 6	6	3	4
4 x 6	6	4	3¾

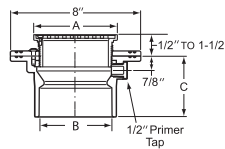

** Floor drains with Stainless Steel tops are rated as "Heavy Duty" per ASME A 112.6.3. Stainless Steel drain tops, grates on floor drains and floor cleanouts are purchased items and not of domestic manufacture.

PART NO. AW 180MS**

Floor Drain with Stainless Steel Adjustable Top with 8" Round Grate and Membrane Collar

SIZE	A	B	C
1½ x 8	8	1½	4¾ ₁₆
2 x 8	8	2	4
3 x 8	8	3	4
4 x 8	8	4	3¾

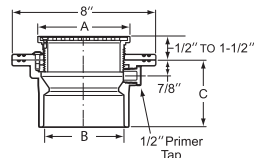

CHEM DRAIN CPVC FITTINGS

PART NO. AW 300C

1/4 Bend
(Sanitary 90° Ell)
ALL HUB

SIZE	A
1½	1¾
2	2 ⁵ / ₁₆
3	3 ¹ / ₁₆
4	3 ⁷ / ₈
6	5
8	6

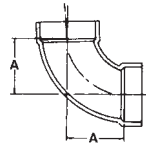

PART NO. AW 302C

1/4 Bend, Street
(Sanitary 90° Street Ell)
SPIGOT X HUB

SIZE	A	B
1½	1¾	2½
2	2 ⁵ / ₁₆	3 ³ / ₁₆
3	3 ¹ / ₁₆	4 ⁹ / ₁₆
4	3 ⁷ / ₈	5 ⁵ / ₈
6	5 ³ / ₁₆	8 ¹ / ₈

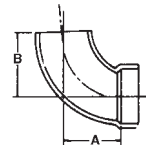

** Floor drains with Stainless Steel tops are rated as "Heavy Duty" per ASME A 112.6.3. Stainless Steel drain tops, grates on floor drains and floor cleanouts are purchased items and not of domestic manufacture.

PART NO. AW 304C

Long Sweep 1/4 Bend
HUB X HUB

SIZE	A
1½	2¾
2	3¼
3	4¼
4	4 ¹⁵ / ₁₆

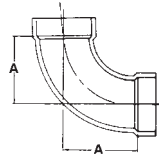

PART NO. AW 321C

1/8 Bend
(45° Ell)
HUB X HUB

SIZE	A
1½	1⅞
2	1½
3	1¾
4	2 ³ / ₁₆
6	2 ¹ / ₁₆
8	2 ¹ / ₁₆

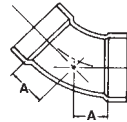

PART NO. AW 323C

1/8 Bend, Street
(45° Street Ell)
SPIGOT X HUB

SIZE	A	B
1½	1⅞	1⅞
2	1½	2 ³ / ₈
3	1¾	3¼
4	2 ³ / ₁₆	3 ¹⁵ / ₁₆
6	2 ¹ / ₁₆	5 ¹⁵ / ₆₄
8	2	6 ³ / ₃₂

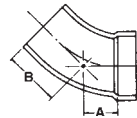

PART NO. AW 324C

1/16 Bend
(22½° EI)
HUB X HUB

SIZE	A
1½	½
2	11/16
3	13/16
4	1
6	1½
8	1½

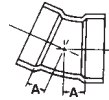

CHEM DRAIN CPVC FITTINGS

PART NO. AW 326C

1/16 Bend, Street
(22½° Street EI)
SPIGOT X HUB

SIZE	A	B
1½	½	1¼
2	11/16	1½
3	13/16	25/16
4	1	2¾
6	1½	53/64
8	1¾	55/8

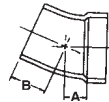

PART NO. AW 327C

Double 1/4 Bend
ALL HUB

SIZE	A	B
1½	1¾	1¾
2	25/16	25/16
3	31/16	31/16

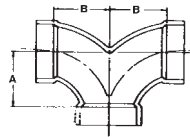

PART NO. AW 400C

Sanitary Tee
ALL HUB

SIZE	A	B
1½	1¾	2¾
2	2 ⁵ / ₁₆	3 ¹¹ / ₁₆
3	3 ¹ / ₁₆	4 ⁷ / ₈
4	3 ⁷ / ₈	6 ¹ / ₈
6	5	8 ¹ / ₂
8	6	10 ¹ / ₂

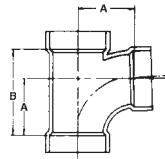

PART NO. AW 401C

Sanitary Tee, Reducing
ALL HUB

SIZE	A	B	C
2 x 1½ x 1½	2 ³ / ₁₆	3 ¹ / ₈	1 ¹⁵ / ₁₆
2 x 1½ x 2	2 ⁵ / ₁₆	3 ¹¹ / ₁₆	2 ⁵ / ₁₆
2 x 2 x 1½	2 ³ / ₁₆	3 ¹ / ₈	1 ¹⁵ / ₁₆
3 x 3 x 1½	2 ⁹ / ₁₆	2 ¹¹ / ₁₆	1¾
3 x 3 x 2	2 ⁷ / ₈	3 ⁵ / ₁₆	2 ¹ / ₈
4 x 4 x 2	3 ⁵ / ₁₆	3 ³ / ₁₆	2 ¹ / ₁₆
4 x 4 x 3	3 ⁹ / ₁₆	4 ³ / ₄	3
6 x 6 x 4	4 ²⁷ / ₃₂	6 ³ / ₆₄	3 ²⁵ / ₃₂
8 x 8 x 4	8¼	6¾	4 ¹ / ₈

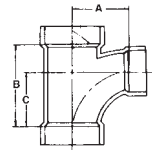

PART NO. AW 428C

Double Sanitary Tee
(Sanitary Cross)
ALL HUB

SIZE	A	B
1½	1¾	2¾
2	2 ⁵ / ₁₆	3 ¹¹ / ₁₆
3	3 ¹ / ₁₆	4 ⁷ / ₈
4	3 ⁷ / ₈	6 ¹ / ₈

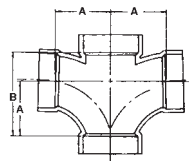

PART NO. AW 429C

Double Sanitary Tee, Reducing
(Sanitary Cross)
ALL HUB

SIZE	A	B	C
2 x 2 x 1½ x 1½	2 ³ / ₁₆	3 ¹ / ₈	1 ¹⁵ / ₁₆
3 x 3 x 1½ x 1½	2 ⁹ / ₁₆	2 ¹¹ / ₁₆	1 ³ / ₄
3 x 3 x 2 x 2	2 ⁷ / ₈	3 ⁵ / ₁₆	2 ¹ / ₈
4 x 4 x 2 x 2	3 ⁵ / ₁₆	3 ³ / ₁₆	2 ¹ / ₁₆
4 x 4 x 3 x 3	3 ⁹ / ₁₆	4 ³ / ₄	3

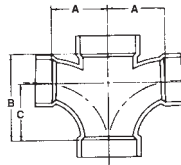

CHEM DRAIN CPVC FITTINGS

PART NO. AW 444XC

Cleanout Tee
with Cleanout Plug
HUB X HUB X FPT

SIZE	A	B	C
1½	1 ¹⁵ / ₁₆	2 ³ / ₈	1 ³ / ₁₆
2	2 ¹ / ₄	3	1 ¹ / ₂
3	2 ¹¹ / ₁₆	3 ⁷ / ₈	1 ¹⁵ / ₁₆
4	3 ³ / ₈	5 ¹ / ₈	2 ⁹ / ₁₆
6	4	8	4

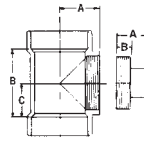

Cleanout Plug
MPT

SIZE	A	B
1½	1 ³ / ₈	5 ⁵ / ₈
2	1 ³ / ₈	5 ⁵ / ₈
3	1 ³ / ₄	3 ³ / ₄
4	1 ⁷ / ₈	7 ⁵ / ₈
6	2	1

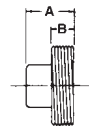

PART NO. AW 501C

Combination Wye and 1/8 Bend
(One Piece)
ALL HUB

SIZE	A	B	C
1½	3 ⁵ / ₁₆	3½	3 ¹⁵ / ₁₆
2	5 ¹ / ₈	4 ⁷ / ₁₆	5 ¹ / ₈
3	7 ⁹ / ₁₆	6½	7 ⁹ / ₁₆
4	10	8½	10

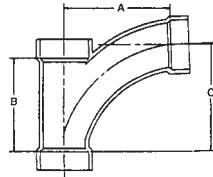

PART NO. AW 502C

Combination Wye and 1/8 Bend, Reducing
(One Piece)
ALL HUB

SIZE	A	B	C
2 x 1½ x 1½	4 ³ / ₁₆	3½	3 ¹⁵ / ₁₆
2 x 2 x 1½	4 ³ / ₁₆	3½	3 ¹⁵ / ₁₆
3 x 3 x 1½	4 ³ / ₄	3½	3 ¹⁵ / ₁₆
3 x 3 x 2	5 ¹¹ / ₁₆	4 ⁷ / ₁₆	5 ¹ / ₈
4 x 4 x 2	6 ¹ / ₈	4½	5 ¹ / ₈
4 x 4 x 3	8 ¹ / ₁₆	6½	7 ⁹ / ₁₆

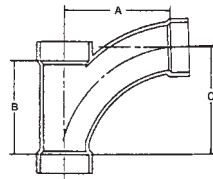

PART NO. AW 503C

Combination Wye and 1/8 Bend
ALL HUB

SIZE	A	B	C
6**	11 ¹⁵ / ₃₂	10 ⁵ / ₃₂	11 ⁹ / ₆₄
8**	14 ¹⁹ / ₃₂	14 ¹ / ₃₂	14 ²³ / ₃₂

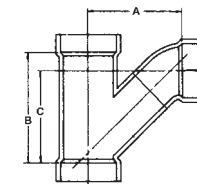

** Two pieces

PART NO. AW 504C

Combination Wye and 1/8 Bend, Reducing

SIZE	ALL HUB		
	A	B	C
6 x 6 x 3**	9 ³ / ₈	7 ⁵ / ₆₄	7 ¹⁹ / ₃₂
6 x 6 x 4*	8 ¹⁵ / ₁₆	8 ⁵ / ₈	7 ¹³ / ₁₆

* One piece short pattern
** Two pieces

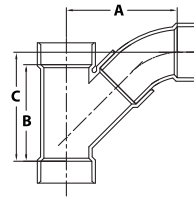

CHEM DRAIN CPVC FITTINGS

PART NO. AW 507C

Double Combination Wye and 1/8 Bend

SIZE	ALL HUB		
	A	B	C
1 ¹ / ₂ †	3 ³ / ₈	3 ⁷ / ₈	3 ³ / ₈
2†	5 ¹⁷ / ₆₄	5 ³ / ₈	4 ²⁷ / ₆₄
2x2x1 ¹ / ₂ x1 ¹ / ₂ †	4 ⁵ / ₃₂	4 ⁷ / ₃₂	3 ⁶ / ₁₆
3†	6 ¹ / ₄	7 ⁵ / ₈	6 ⁵ / ₁₆
3x3x2x2†	6 ⁵ / ₆₄	5 ⁵ / ₃₂	5 ¹¹ / ₆₄
4†	9 ¹³ / ₃₂	8 ³ / ₁₆	9 ⁵ / ₃₂
4x4x2x2†	7 ⁵ / ₁₆	5	6
4x4x3x3†	8 ¹⁹ / ₆₄	6 ⁹ / ₁₆	7 ¹⁹ / ₃₂
6†	11 ²¹ / ₃₂	11 ¹¹ / ₃₂	10 ³ / ₁₆
6x6x3x3†	12 ¹ / ₈	10 ⁹ / ₆₄	11 ⁵ / ₈
6x6x4x4†	12 ¹ / ₈	10 ⁹ / ₆₄	11 ⁵ / ₈

† Three pieces.

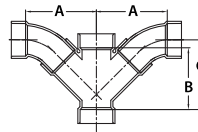

PART NO. AW 600C

SIZE	Wye (45° Wye) ALL HUB		
	A	B	C
1½	4	1⅛	2⅞
2	5	1⅜	3⅝
3	6⅝	1⅝	5
4	8¼	1⅞	6⅜
6	10¾	1¾	8⅞
8	14⅛	2⅜	11¾

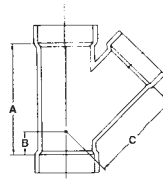

PART NO. AW 601C

SIZE	Wye, Reducing (45° Wye) ALL HUB		
	A	B	C
2 x 1½ x 1½	3½	1⅛	2⅞
2 x 2 x 1½	4½	1	3⅞
3 x 3 x 1½	4¼	½	4⅞
3 x 3 x 2	5	⅞	4⅞
4 x 4 x 1½	5	0	6
4 x 4 x 2	5⅛	⅜	5⅞
4 x 4 x 3	6⅝	1⅛	6
6 x 6 x 4	6⅞	⅜	7½
8 x 8 x 4	10 ½	1	11⅞
8 x 8 x 6	10 ½	1	9⅞

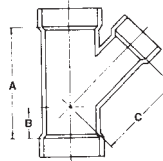

PART NO. AW 611C

Double Wye
(Double 45° Wye)
ALL HUB

SIZE	A	B	C
1½	4	1⅛	2⅞
2	5	1⅜	3⅝
3	6⅝	1⅝	5
4	8¼	1⅞	6⅝
6	10¾	1¾	8⅞

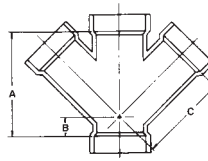

CHEM DRAIN CPVC FITTINGS

PART NO. AW 612C

Double Wye, Reducing
(Double 45° Wye)
ALL HUB

SIZE	A	B	C
2 x 2 x 1½ x 1½	4⅜	1⅛	3⅞
3 x 3 x 2 x 2	5	7⁄8	4⅝
4 x 4 x 3 x 3	6⅝	1⅛	6
6 x 6 x 4 x 4	10¾	1¾	10⅞

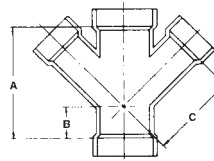

PART NO. AW 706XC

P-Trap with Solvent Weld Joint
HUB X HUB

SIZE	A	B	C
1½	4⅝	3⅛	1¾
2	6⅜	4⅞	2⅞
3	8⅛	6⅝	3⅞
4	11¼	8⅞	4⅞
6	18⅝	14⅜	7⅞

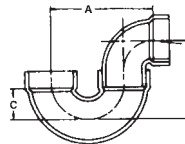

PART NO. AW 707XC

**P-Trap with Cleanout,
Solvent Weld Joint**

SIZE	HUB X HUB		
	A	B	C
1½	4 ⁵ / ₈	3 ¹⁵ / ₁₆	1¾
2	6 ¹³ / ₁₆	4 ⁷ / ₈	2 ³ / ₈

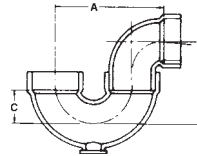

PART NO. AW 708PC

P-Trap with Union

SIZE	HUB X HUB WITH PLASTIC NUT		
	A	B	C
1½	4 ⁵ / ₈	3 ¹⁵ / ₁₆	1¾
2	6 ¹³ / ₁₆	4 ⁷ / ₈	2 ³ / ₈

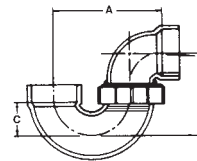

PART NO. AW 711PC

L.A. Pattern P-Trap with Union

SIZE	SLIP X HUB WITH PLASTIC NUTS		
	A	B	C
1½	4 ⁵ / ₈	3 ¹⁵ / ₁₆	3¾

§Nut is sized to fit tubular sink tailpieces.

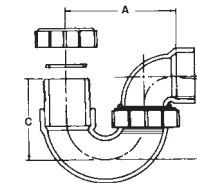

PART NO. AW 712C

Jar Trap
SLIP X HUB

SIZE	A	B	C	D
1½	3⅞	8¼	3⅞	2

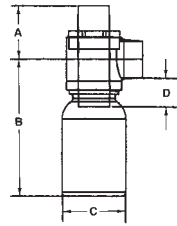

CHEM DRAIN CPVC FITTINGS

PART NO. AW 712PC

Jar Trap with Tail Piece Adaptor
SLIP X HUB WITH PLASTIC NUTS

SIZE	A	B	C	D
1½	3⅞	8⅝	3⅞	2

§Nut is sized to fit tubular sink tailpieces.

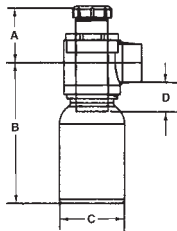

PART NO. AW 1512PC

CPVC Tail Piece with Nut‡

(May be cut to length)

Supplied with a Fluoroelastomer Gasket

SIZE	A	B
1½ x 6	6	1½
1½ x 12	12	1½

‡ Tubular O.D.

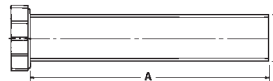

Shading indicates new item.

PART NO. AW 1500C*

**Floor Drain with CPVC Adjustable Top
with 5" Round Grate**

SIZE	A	B	C
1½ x 5	1½	5	4 ³ / ₁₆
2 x 5	2	5	4
3 x 5	3	5	4
4 x 5	4	5	3¾

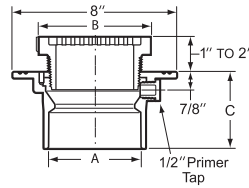

PART NO. AW 1510S**

**Floor Cleanout with Stainless Steel
Adjustable Round Top and
Solid Access Cover**

SIZE	A	B	C
1½ x 5	1½	5	4 ³ / ₁₆
2 x 5	2	5	4
3 x 5	3	5	4
4 x 5	4	5	3¾

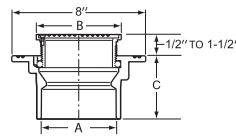

PART NO. AW 1520C*

**Floor Drain with CPVC Adjustable Top
with 5" Round Grate and Strainer**

SIZE	A	B	C
1½ x 5	1½	5	4 ³ / ₁₆
2 x 5	2	5	4
3 x 5	3	5	4
4 x 5	4	5	3¾

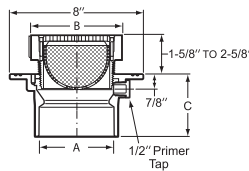

* Floor drains with CPVC tops are rated as "Light Duty" per ASME A 112.6.3. Any metallic screws or hardware are 304 SS. All floor drains are supplied with ½" FPT tapped connection for a trap primer. All drains and clean-outs are based on 4" body with smaller connection sizes factory bushed.

** Floor drains with Stainless Steel tops are rated as "Heavy Duty" per ASME A 112.6.3. Stainless Steel drain tops, grates on floor drains and floor cleanouts are purchased items and not of domestic manufacture.

PART NO. AW 1600S**

Floor Drain with Stainless Steel Adjustable Top with 6" Round Grate

SIZE	A	B	C
1½ X 6	1½	6	4 ³ / ₁₆
2 X 6	2	6	4
3 X 6	3	6	4
4 X 6	4	6	3¾

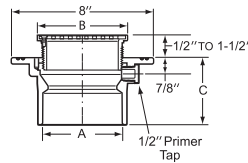

**CHEM
DRAIN
CPVC
FITTINGS**

PART NO. AW 1800S**

Floor Drain with Stainless Steel Adjustable Top with 8" Round Grate

SIZE	A	B	C
1½ X 8	1½	8	4 ³ / ₁₆
2 X 8	2	8	4
3 X 8	3	8	4
4 X 8	4	8	3¾

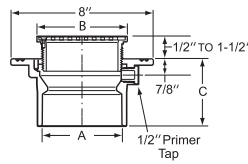

** Floor drains with Stainless Steel tops are rated as "Heavy Duty" per ASME A 112.6.3. Stainless Steel drain tops, grates on floor drains and floor cleanouts are purchased items and not of domestic manufacture.

PART NO. AW 8530C

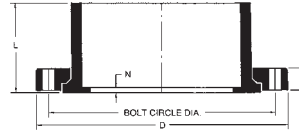
Van Stone Flange
 SOCKET

Size	D	L	N	R
1 1/2	4 15/16	1 9/16	3/32	23/32
2	5 7/8	2 23/32	3/32	13/16
3	7 7/16	2 1/8	1/8	29/32
4	9 1/32	2 5/8	1/8	1 1/16
6	10 31/32	3 7/32	1/8	1 7/32
8	13 11/32	4 5/16	3/16	1 1/2

Size	BOLT CIRCLE DIA.	BOLT HOLE DIA.	NO. OF BOLT HOLES	BOLT DIA.	MIN. BOLT LENGTH*
1 1/2	3 7/8	5/8	4	1/2	2 1/2
2	4 3/4	3/4	4	5/8	3
3	6 5/8	3/4	4	5/8	3 1/4
4	7 1/2	3/4	8	5/8	3 1/2
6	9 1/2	31/32	8	3/4	4
8	11 3/4	29/32	8	3/4	4 1/2

* Bolt lengths were calculated using two Charlotte flanges.
 Lengths may vary when mating with other brands or accessories.

NOTES

CHARLOTTE
PIPE AND FOUNDRY COMPANY®

NOTES

CHARLOTTE
PIPE AND FOUNDRY COMPANY®

LIMITED WARRANTY

Charlotte Pipe and Foundry Company® (Charlotte Pipe®) Products are warranted to be free from manufacturing defects and to conform to currently applicable ASTM standards for a period of five (5) years from date of delivery. Buyer's remedy for breach of this warranty is limited to replacement of, or credit for, the defective product. This warranty excludes any expense for removal or reinstallation of any defective product and any other incidental, consequential, or punitive damages. **This limited warranty is the only warranty made by seller and is expressly in lieu of all other warranties, express and implied, including any warranties of merchantability and fitness for a particular purpose.** No statement, conduct or description by Charlotte Pipe or its representative, in addition to or beyond this Limited Warranty, shall constitute a warranty. This Limited Warranty may only be modified in writing signed by an officer of Charlotte Pipe.

This Limited Warranty will not apply if:

- 1) The Products are used for purposes other than their intended purpose as defined by local plumbing and building codes, and the applicable ASTM standard.
- 2) The Products are not installed in good and workmanlike manner consistent with normal industry standards; installed in compliance with the latest instructions published by Charlotte Pipe and good plumbing practices; and installed in conformance with all applicable plumbing, fire and building code requirements.
- 3) This limited warranty does not apply when the products of Charlotte Pipe are used with the products of other manufacturers that do not meet the applicable ASTM or CISPI standards or that are not marked in a manner to indicate the entity that manufactured them.
- 4) The Products fail due to defects or deficiencies in design, engineering, or installation of the piping system of which they are a part.
- 5) The Products have been the subject of modification; misuse; misapplication; improper maintenance or repair; damage caused by the fault or negligence of anyone other than Charlotte Pipe; or any other act or event beyond the control of Charlotte Pipe.
- 6) The Products fail due to the freezing of water in the Products.
- 7) The Products fail due to contact with chemical agents, fire stopping materials, thread sealant, plasticized vinyl products, or other aggressive chemical agents that are not compatible.
- 8) Pipe outlets, sound attenuation systems or other devices are permanently attached to the surface of Charlotte® PVC, ABS or CPVC products with solvent cement or adhesive glue.

Charlotte Pipe products are manufactured to the applicable ASTM or CISPI standard. Charlotte Pipe and Foundry **cannot** accept responsibility for the performance, dimensional accuracy, or compatibility of pipe, fittings, gaskets, or couplings not manufactured or sold by Charlotte Pipe and Foundry.

Any Charlotte Pipe products alleged to be defective **must** be made available to Charlotte Pipe at the following address for verification, inspection and determination of cause:

Charlotte Pipe and Foundry Company
Attention: Technical Services
2109 Randolph Road
Charlotte, North Carolina 28207

⚠ WARNING

Testing with or use of compressed air or gas in PVC / ABS / CPVC / Cast Iron pipe or fittings can result in explosive failures and cause severe injury or death.

AIR/GAS



- NEVER test with or transport/store compressed air or gas in PVC / ABS / CPVC / Cast Iron pipe or fittings.
- NEVER test PVC / ABS / CPVC / Cast Iron pipe or fittings with compressed air or gas, or air over water boosters.
- ONLY use PVC / ABS / CPVC / Cast Iron pipe or fittings for water or approved chemicals.
- Refer to warnings in PFFA User Bulletin 4-80 and ASTM D 1785.

Purchaser must obtain a return materials authorization and instructions for return shipment to Charlotte Pipe of any product claimed defective or shipped in error.

Any Charlotte Pipe product **proved** to be defective in manufacture will be replaced F.O.B. point of original delivery, or credit will be issued, at the discretion of Charlotte Pipe.

4/15/10

Charlotte and Charlotte Pipe are registered trademarks of Charlotte Pipe and Foundry Company.

CHARLOTTE
PIPE AND FOUNDRY COMPANY

PO BOX 35430

CHARLOTTE

NORTH CAROLINA 28235

PHONE (704) 348-6450

(800) 438-6091

FAX (800) 553-1605

LITERATURE BY FAX (800) 745-9382

WWW.CHARLOTTEPIPE.COM

